



TMY01 USER MANUAL

TMY01 User manual

Index	1,2,3
1. Preface	4
2. Introduction	4
2.1 Overview	4
2.2 Specifications.....	5
2.3 Main Features and Use Cases	5
2.3.1 Intelligent Tracking.....	6
2.3.2 Multiple Wake-up Mechanisms	6
2.3.3 Position Monitor.....	6
2.3.4 LBS.....	6
2.3.5 Blind Zone Compensation.....	7
2.3.6 Battery Level Detection	7
2.3.7 Optical Sensor.....	7
3 Working Modes	8
3.1 Introduction	8
3.2 Usage Table	8
3.3 Parameter Table	8
3.4 Always On Mode	9
3.4.1 Introduction	9
3.4.2 Configuration Example	9
3.5 Periodic Mode.....	10
3.5.1 Introduction	10
3.5.2 Configuration Example	10
4 Device Data Fields.....	11
5 Troubleshooting	12
5.1 Inaccurate positioning of LBS	12

5.2 The device is offline.....	12
5.3 Unable to boot.....	12
5.4 No optical sensor alert.....	13
6 Installation Instructions.....	13
6.1 Getting Started.....	13
6.2 SIM Card Installation.....	15
6.3 Device Power Up.....	15
6.4 Device Installation.....	15

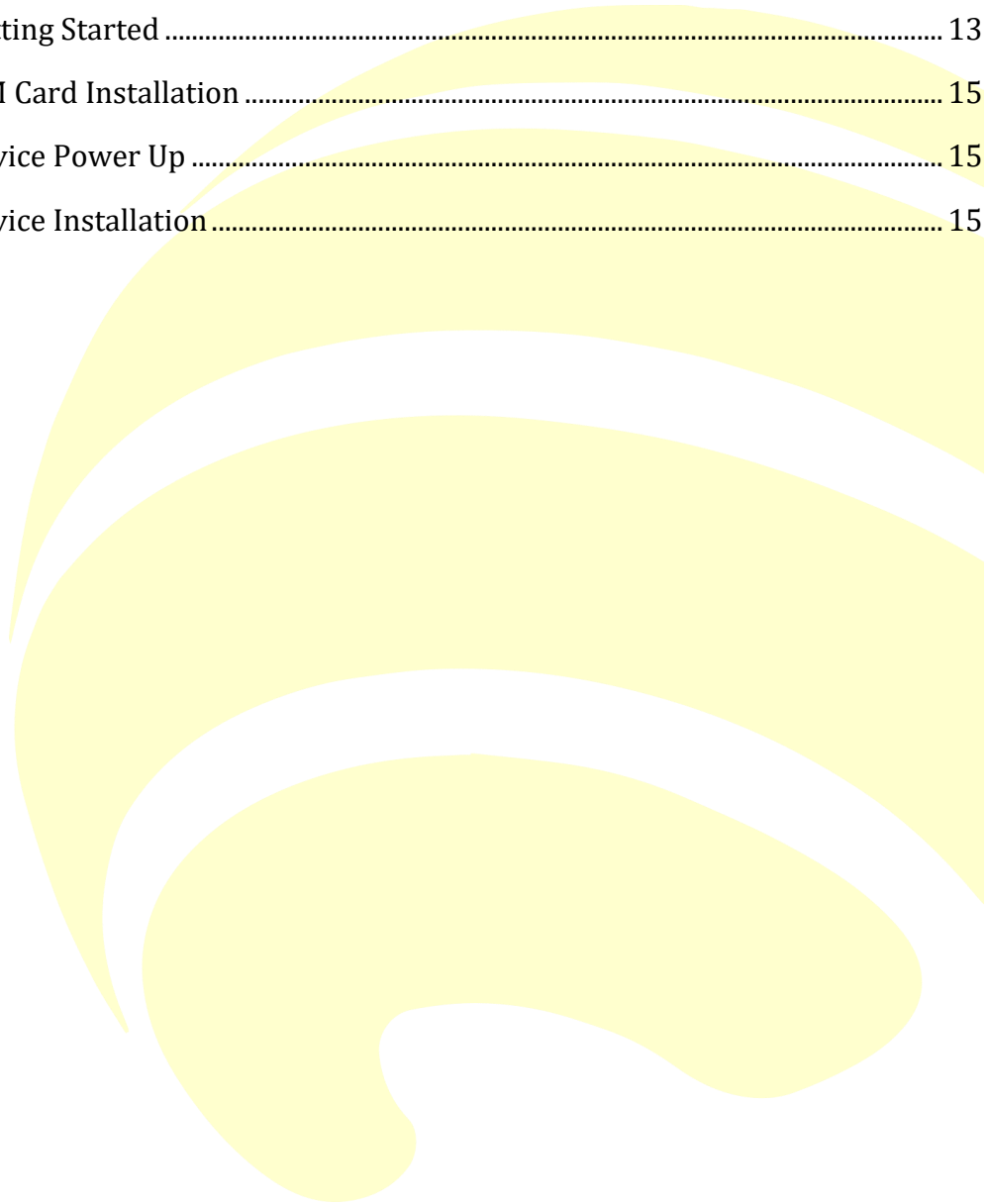

TMY01 User Manual

1. Preface

This guide provides the user with an overview of the features available on the TMY01 device. In this manual, Platform means the ThingsMatrix Service Platform.

2. Introduction

2.1 Overview

TMY01 is a simplified asset tracking device based on 2G cellular technology and built for applications requiring only location information. Its compact design makes it ideally suited for use cases where space is limited.

Additional details re as follows:

- Easy installation without wires
- Built-in disposable lithium-ion battery with a working temperature range of -20°C to +60°C. It has an ultra-low, self-discharge rate and extremely wide temperature capability
- Ultra-long battery life
- Compared to similar products available on the market, TMY01 is small and ideal to be easily hidden
- Integrated optical sensor to provide a tamper alert
- Supports global connectivity with embedded 2G module

2.2 Specifications

More detailed specifications are as follows:

Table 1 – TMY01 Specifications

Category	Specification	Description
Cellular Network	EDGE/GSM/GPRS	850/900/1800/1900MHz
Electrical	Power Supply	Non-Rechargeable Battery
	Battery	1200mAh, 6V 6 days @ 1 report/10min 2 year @ 1 report/day
Physical	Size	60x31x22mm
	IP Rating	Non-waterproof
	Embedded Sensors	Optical sensor
Data Transfer	GPRS	85.6kbps DL; 85.6kbps UL
Location	LBS	Supported
	GPS	Supported
	Sensitivity	Cold Start -149dbm
	Accuracy	<2.5m CEP
Environmental	Temperature	-20°C ~ +60°C
	Humidity	95%RH
Antenna/SIM	GPS Antenna	Internal
	Cellular Antenna	Internal
	SIM Form Factor	Micro-SIM (3FF)
Certification	FCC	No
	CE	No
	PTCRB	No
Device Management	Data Monitoring	Supported
	Device Configuration	Supported
	Firmware Upgrade	Supported

2.3 Main Features and Use Cases

Table 2 – TMY01 Features

Supported Features	Configuration on the Platform required?
Intelligent Tracking	Yes
Wake-up Mechanisms	Yes

Position Monitor	No
LBS	No
Blind Zone Compensation	No
Battery Power Detection	Yes (if battery level alert is required)
Optical Sensor	No

2.3.1 Intelligent Tracking

Always On Mode can be set on the Platform in case of an emergency (e.g. theft) so that the real-time location of the device can be monitored. Upon receiving the tracking command from the Platform, the device switches into Always On Mode. In this mode, the device periodically reports the location information to the platform following a pre-configured reporting interval until a stop tracking command is received. For more details, please refer to **Chapter 3.4.1 Introduction**.

2.3.2 Multiple Wake-up Mechanisms

TMY01 supports multiple wake-up mechanisms:

- The user can set a wake-up interval on the Platform to awake the device periodically
- The user can modify the device wake-up time schedule on the Platform in order to wake-up the device at a fixed time. A device can be configured for one wake-up time point, which is used for more accurate positioning and for a better connection to the server
- The wake-up feature must be set and enabled from the Platform

2.3.3 Position Monitor

The Position Monitor feature is enabled by default, which means the TMY01 will report location information in every report. The information includes: Position fix technology (LBS/GPS), longitude and latitude, cellular signal strength, battery voltage, cell ID, etc. All the device information reported is displayed on the Platform.

For further information, please refer to **Assets Management Service - Device List** section in ThingsMatrix Service Platform User Guide.

2.3.4 LBS

LBS provides the location information by utilizing the carrier network signal. It is enabled when the TMY01 does not have GPS location information. *Please note that LBS is largely dependent on distance to surrounding network cell sites, which could be up to a few miles away in worst case scenarios. It is not as accurate as GPS.*

This feature is enabled by default. The LBS data is displayed on the Platform. Please refer to **Assets Management Service - Device List** section in ThingsMatrix Service Platform User Guide to get further information.

2.3.5 Blind Zone Compensation

When the device enters a cellular connectivity/coverage blind zone (limited or no cellular signal), it will store the collected data according to the preconfigured reporting frequency, and will upload this data to the Platform once the cellular signal is recovered. The maximum number of blind zone compensation data reports is 4096.

This feature is enabled by default on the Platform.

2.3.6 Battery Level Detection

The device will upload the battery level status together with the location coordinates. The battery level will be displayed on the Platform.

The device, by default, reports power information without any additional configuration on the Platform. Please refer to **Assets Management Service - Device List** section in the ThingsMatrix Service Platform User Guide to get further details. The device will report the low battery alarm to the platform when the battery power is lower than 20%. If the user wants to change the battery level alert, this can be done by configuring a policy on the Platform. Please refer to the **Data Management Service - Policy** section within the ThingsMatrix Service Platform User Guide.

2.3.7 Optical Sensor

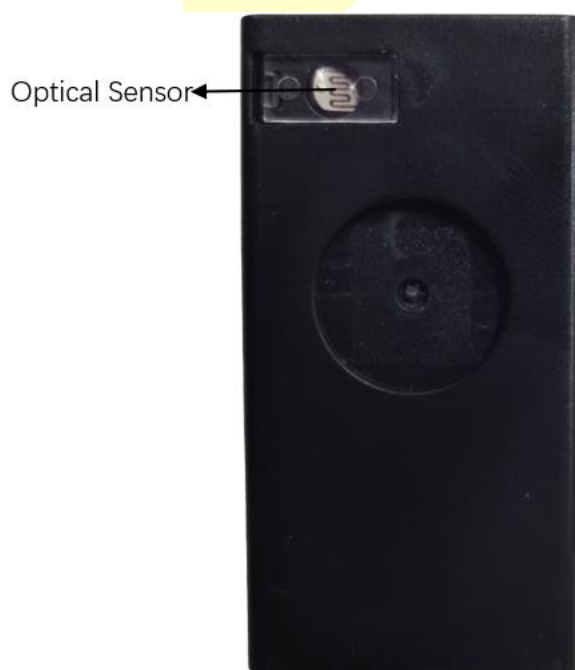

The TMY01 has a built-in optical sensor. When the device is removed after installation and the sensor is exposed to light, it will be activated immediately and the TMY01 will send a “DEVICE_REMOVED” alarm message to the Platform, together with the current location data.

Information relevant to the “DEVICE_REMOVED” alarm is displayed on the Platform (including alert icon, alert record, etc.). Please refer to **Assets Management Service - Device List** section in ThingsMatrix Service Platform User Guide to get more details.

3 Working Modes

3.1 Introduction

The TMY01 has two working modes: Always On, Periodic.

User can select the working mode according to a specific use scenario (refer to **Table 3**).

3.2 Usage Table

Table 3 – TMY01 Usage

Working Mode	Use Case
Always On	<ol style="list-style-type: none"> 1. Always On Mode is used when the device needs to be active all the time and upload the location data according to the interval preconfigured by the user. 2. Always On Mode is active all the time, preventing the device to enter sleep mode, and thus increasing battery consumption.
Periodic	Periodic Mode means the device will report the data according fixed report interval. The default value is 5 minutes.

3.3 Parameter Table

Table 4 – TMY01 Parameters

Category	Parameter	Definition	Remark
Working Mode	Mode	Work Mode	<p>Users can select the required working mode through the drop-down box.</p> <p>There are two options: Always On, Periodic.</p> <p>For example, selecting the “Always On” option will cause the device to activate the “Always On” mode.</p>
Generic Settings	Heartbeat timer	TCP Keepalive Timer	<p>Unit: second; Range: 60~14400. The default value is 120.</p> <p>For example, setting the parameter "Heartbeat timer: 300" will cause the device to send a heartbeat packet to the platform every 5 minutes to notify the platform that the device is still online.</p>

Periodic Mode Settings	Report Interval	Time interval for position information	<i>Unit: second. The default value is 300.</i> For example, setting the parameter "Report Interval: 300" will cause the device to report data every 300 seconds when the device works continuously.
	Sleep Duration	Hibernation Timer	<i>Unit: second. The default value is 86400.</i> For example, setting the parameter "Sleep Duration: 86400" will cause the device to wake up every 24 hours.
	Working Duration	Working Timer	<i>Unit: second. The default value is 150.</i> For example, setting the parameter "Working Duration: 150" will cause the device to work continuously for 150 seconds after waking up.
	Fixed Wakeup Time	Specify the next wake-up time	<i>Parameter format: "HH: mm".</i> For example, setting the parameter to "08:00" will cause the device to wake up at 8:00 and report data.
	Time zone	Time zone	Set the time zone according to the current device location. For example, setting the parameter to "UTC +08:00" will set the time zone to UTC +08:00.
Always On Mode Settings	Report Interval	Time interval of position information	<i>Unit: second. The default value is 300.</i> For example, setting the parameter "Report Interval: 300" will cause the device to report data every 300 seconds.
Threshold Settings	Battery	Low battery alarm boundary value	<i>The default value is 20.</i> For example, setting the parameter "battery: 30" will cause the device to report a low battery alarm to the platform when the battery power reaches 30%.
Firmware Settings	Version	Version	<i>Default: v1.0</i>
	Server	Server	<i>Default: ftp.thingsmatrix.io</i>
	Port	Port	<i>Default: 21</i>
	Username	Username	<i>Default: user</i>
	Password	Password	<i>Default: 123456</i>
	Filename	Filename	<i>Default: filename</i>
Cellular Settings	Network mode	Network Mode	<i>Default: 2G only</i>

3.4 Always On Mode

3.4.1 Introduction

Always On Mode is used when the device needs to be active at all times and location data is uploaded according to the interval preconfigured by the user.

3.4.2 Configuration Example

If the device is required to report data once every 60s, then the user must select Always On Mode. The parameters of Always On Mode can be configured on the platform as shown below:

Configuration

Working Mode Option ⓘ	
Mode Default: Motion	Always On ▾
> Generic Settings ⓘ	
> Periodic Mode Settings ⓘ	
> Flight Mode Settings ⓘ	
Always On Mode Settings ⓘ	
Report Interval Default: 300s	60

3.5 Periodic Mode

3.5.1 Introduction

In Periodic Mode the device can only report data in fixed intervals. It can be used if there are no specific requirements.

3.5.2 Configuration Example

If the device is required to wake up every 24 hours, then work continuously for 5 minutes while reporting data every 150 seconds, Periodic Mode can be configured as follows:

Configuration

v Working Mode Option ⓘ

Mode Periodic v

Default: Motion

> Generic Settings ⓘ

v Periodic Mode Settings ⓘ

Report Interval 150

Default: 300s

Sleep Duration 86400

Default: 86400s

Working Duration 300

Default: 150s

4 Device Data Fields

The IoT Gateway parses the data fields from the device’s communication protocol and converts it to a JSON-formatted data payload. The user can view the data fields in the device’s Status and Statistics tabs on the Platform or via the API. The data fields supported by the device are listed in the table below.

Table 5 – TMY01 Data Field Definitions

Field	Definition	Description
time	Time	It shows the data generated time.
lat	Latitude	It shows the latitude of the device.
lng	Longitude	It shows the longitude of the device.
altitude	Altitude	It shows the altitude of the device.
sn	Device SN	Each device will have a unique serial number for identification
speed	Speed	It shows the speed of the device.
direction	Direction	It shows the direction of the device. North begins at zero degrees clockwise.
Imei	Network Module IMEI	It shows the IMEI of the cellular module.
iccid	SIM ICCID	It shows the SIM ICCID.
signalStrength	Signal Strength (dBm)	It shows Cell Signal Strength.
gpsLocating	Location Mode	It shows the Location Mode: GPS, LBS.
firmware	Firmware Version	It shows the Firmware Version.
ipAddress	IP Address	It shows the IP Address of Connection.

5 Troubleshooting

This section provides information to help the user troubleshoot general issues with the device.

5.1 Inaccurate positioning of LBS

- Problem
 - Wrong location shown in map
- Possible cause
 - The carrier network cell tower that the device is attached to is too far
- Solution
 - Move the device around so it can acquire a GPS signal

5.2 The device is offline

- Problem
 - The device is shown as being offline
- Possible cause
 - The SIM card does not have an active subscription
 - The SIM card is inserted incorrectly
 - The device is asleep
- Solution
 - Replace the SIM card
 - Correct the SIM card installation
 - Expose optical sensor to light or turn the power off and on to wake the device up

5.3 Unable to boot

- Problem
 - The indicator light is off when the device gets powered up
- Possible cause
 - Power switch is in the OFF position

- Battery is depleted
- Solution
 - Slide the power switch to the ON position
 - Replace the battery

5.4 No optical sensor alert

- Problem
 - The optical sensor is exposed to light but there is no LED activity and no alarm
- Possible cause
 - The light intensity is too weak
- Solution
 - Move the device to a position with more light

6 Installation Instructions

The device external appearance is as follows:



6.1 Getting Started

To use the device, the user needs to open the top cover, insert the SIM card correctly, turn the power on, and install the device in place.

The user can open the top cover by hand. There are two LED indicators under the cover: the **blue** LED shows the GPS status, and the **green** LED shows the cellular connectivity status.

Please review the following diagram for the different LED combinations.

Terminology:

- Fast blinking: The indicator light flashes 3-5 times in 1 second
- Slow blinking: The indicator light flashes one times in 2 seconds

Green LED

- Off: Cellular module off
- Slow blinking: Acquiring cellular signal
- Fast blinking: Cellular module attached to network
- Solid On: Successfully connected to the platform

Blue LED

- Off: GPS off
- Slow blinking: Acquiring GPS location
- Solid On: GPS fix successful

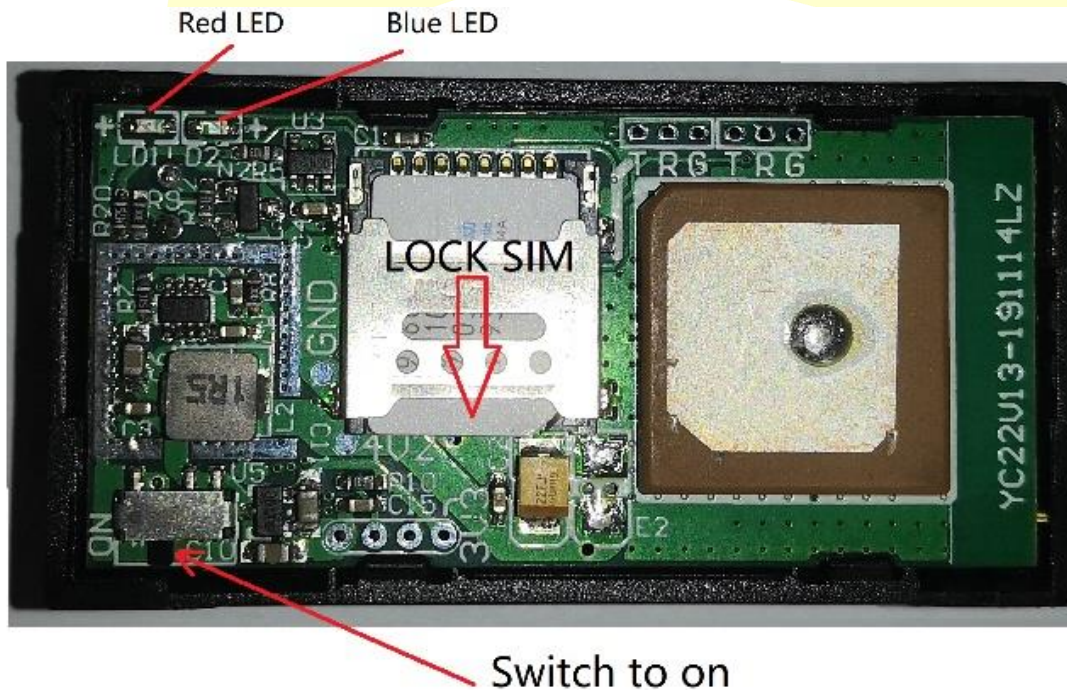

6.2 SIM Card Installation

Open the SIM card holder cover, insert the SIM card into the SIM card holder.

Ensure that the SIM card is properly placed.

Close the SIM card cover.

Please take note of the ICCID on the SIM card and make sure that the SIM card has an active subscription for the required cellular network.

6.3 Device Power Up

After the SIM card is installed, move the power switch to the ON position (please refer to the picture of section 6.1, move the power switch to the right). When the **blue** LED starts blinking, the device is powered up.

6.4 Device Installation

Close the top cover after the device is powered up.

Peel one side of the supplied 3M double sided tape and place it on the bottom of the device (optical sensor side), making sure not to cover the sensor.

Select a place where the device will be installed. Peel the other side of the tape and place it over a clean flat surface pressing down firmly.

If the device is removed, the optical sensor will be activated immediately. The Platform will display a “DEVICE_REMOVED” alarm along with the current location data.